

19/06404/FUL  
Scale 1/2500

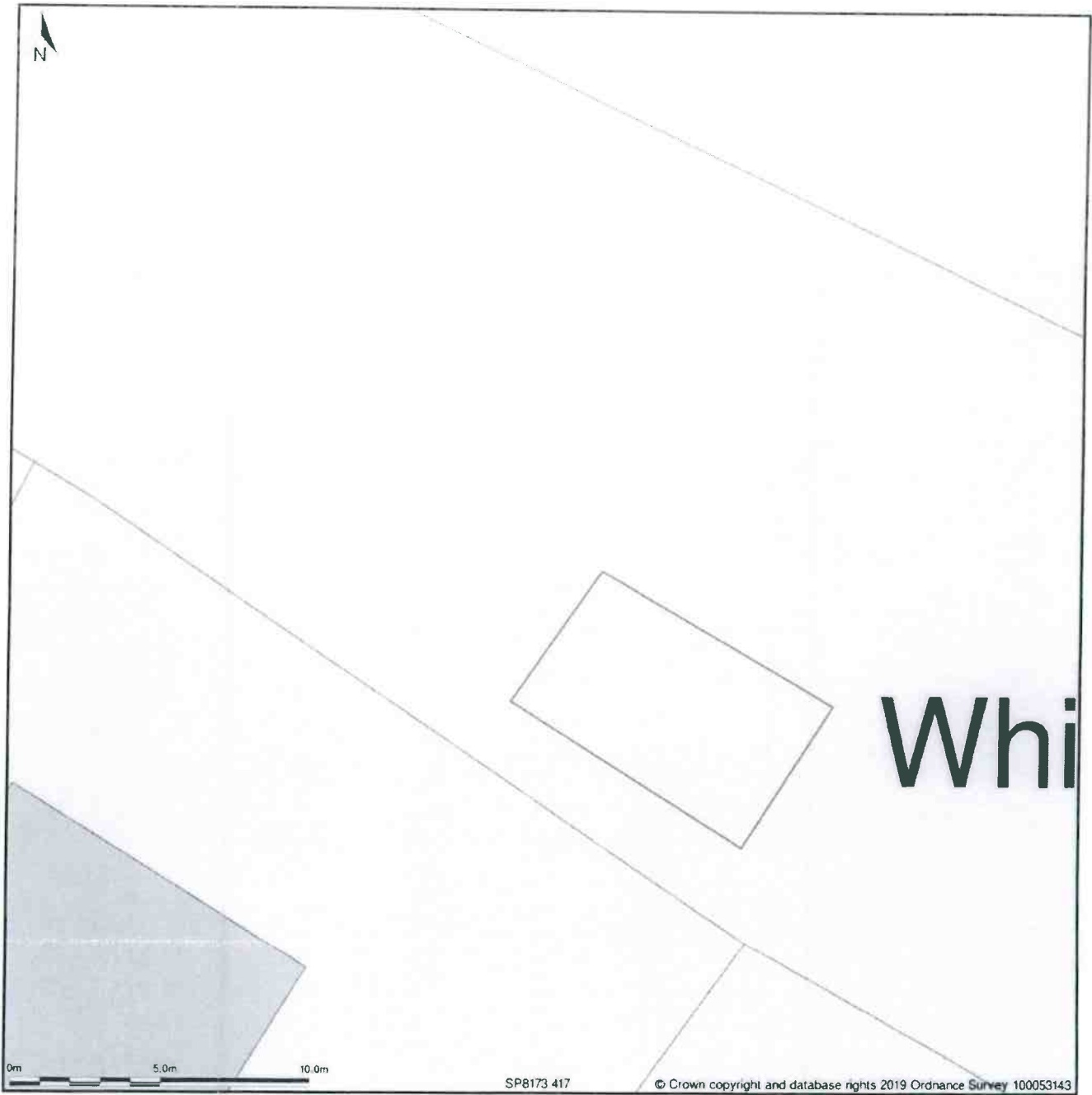

Whiteleaf Lodge, Peters Lane, Monks Risborough, Buckinghamshire, HP27 0LG



Block Plan shows area bounded by: 481712.63, 204157.27, 481748.63, 204193.27 (at a scale of 1:200), OSGridRef: SP8173 417. The representation of a road, track or path is no evidence of a right of way. The representation of features as lines is no evidence of a property boundary.

Produced on 14th Jun 2019 from the Ordnance Survey National Geographic Database and incorporating surveyed revision available at the date of production. Reproduction in whole or part is prohibited without the prior permission of Ordnance Survey. © Crown copyright 2019. Supplied by [www.buyaplan.co.uk](http://www.buyaplan.co.uk) a licensed Ordnance Survey partner (10002943). Unique plan reference: 19/06404

Ordnance Survey and the OS Symbol are registered trademarks of Ordnance Survey, the national mapping agency of Great Britain. Buy A Plan logo, pdf design and the [www.buyaplan.co.uk](http://www.buyaplan.co.uk) website are Copyright © Pass Inc Ltd 2019.

PLANNING  
14 JUN 2019  
WYCOMBE DISTRICT

WDCA

Whiteleaf Lodge, Peters Lane, Monks Risborough, Buckinghamshire, HP27 0JG



Block Plan shows area bounded by: 491663.01, 204115.08 491763.01, 204205.08 (at a scale of 1:600), CSGridRef: SP8173 416. The representation of a road, track or path is no evidence of a right of way. The representation of features as lines is no evidence of a property boundary.

Produced on 22nd Jul 2019 from the Ordnance Survey National Geographic Database and incorporating surveyed revision available at this date. Reproduction in whole or part is prohibited without the prior permission of Ordnance Survey. © Crown copyright 2018. Supplied by www.buyaplan.co.uk a licensed Ordnance Survey partner (100053143). Unique plan reference: R00441069-5C-F17

Ordnance Survey and the OS Symbol are registered trademarks of Ordnance Survey, the national mapping agency of Great Britain. Buy A Plan logo, pdf design and the www.buyaplan.co.uk website are Copyright © Pass Inc Ltd 2019



Proposed Garden Building

Overall size including Road: 11.75M x 2.118M x 4.27M

Internal size: 11.70M x 2.040M

PLANNING  
10 JUN 2019  
WYOMING DISTRICT

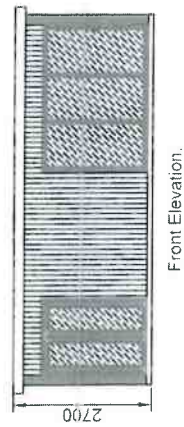

Front Elevation.



Right Elevation.



Rear Elevation.



Left Elevation.

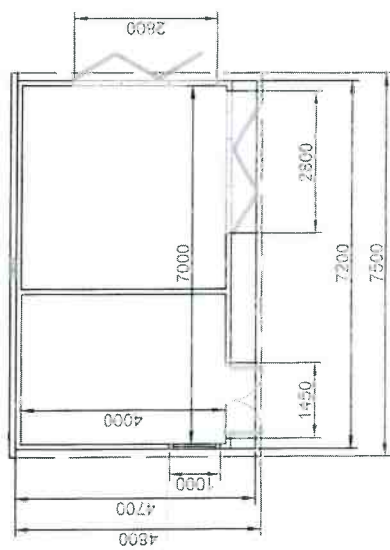

Plain View.

**General Construction Details:**

- Aluminum 2.8m Bi-Fold Doors in Graphite Fitted with Pilkington Glass to front and right elevation.
- Aluminum French doors in Graphite with Pilkington Glass to front elevation.
- UPVC Fullheight 1m Window, frame in graphite gray fitted with Pilkington Glass, non-opening.
- Timber Frame (Tanalized) with 50mm Rockwool Insulated Cavity Incorporating breathable Foiled photon wrap.
- Internal high density particle board with washable surface. (Melamine)
- T & G Cladding Constructed in Natural Cedar to front, left and right elevations, fascia and hood interior.
- Tanalized Redwood shiplap cladding to rear elevation.
- Roof Kingspan 65-20mm thick insulated composite panels - Olive Green Finish.

19/06404 B

MCC2

Client Name	1100 Allwood Drive, Unit 43
Client	Prolog
Designer	DM
Date	07/06/2018
Drawn	
Scale	1:50
Project	19/06404 B